



Switchable High Amp Circuit Breaker

Type III Vehicle Protection

Manual Reset with On-Off function

5,000 Amp (U3) Interrupt Capacity

Ignition-Protected

IP66 Weatherproof

SERIES 87

RAISING THE BAR
MP - COUNT ON IT



SUPERIOR CIRCUIT PROTECTION

www.mechprod.com

Series 87 Overview

FEATURES:

Panel and surface mount with On-Off switch function
Wider Amperage Range - **25 to 250 Amp**
Single pole thermal breaker with manual reset
Main Breaker Protection Interrupt Rating
5,000A (U3) interrupt capacity
Ignition protected
IP66 Weatherproof

- Robust **5/16"-18 or 3/8"-16 studs**
- Round hole mounting cutout
- Industry standard mounting
- Double set of contacts
- Trip Free design

Series 87 Specifications

Standard Amp Ratings	25, 30, 35, 40, 50, 60, 70, 80, 90, 100, 110, 120, 135, 150, 175, 200 (225, & 250 Consult Factory)
Maximum Voltage Ratings	Type III: 48 VDC
Ultimate Trip	Must Hold 100% at 25°C/77°F Must Trip at 135% within 1 hour
Dielectric Strength	1,500VAC Minimum
Interrupt Capacity	5,000A @ 14VDC 3,000A @ 28VDC 1,500A @ 48VDC
Cycle Endurance	Switching 2000 cycles at rated current and voltage.
Operating Temperature Range	-40°C/-40°F to 85°C/185°F
Materials	Thermoset Polyester
Termination	5/16"-18 or 3/8"-16 threaded studs
Torque Rating	75 in-lbs for 5/16-18", 100 in-lbs for 3/8"-16
Mounting Hole	#10 or M5 screw
Weight	
	Environmental
Ignition Protected	Compliant to SAE J1171
Ingress Protection	IP66
Corrosion	Conforms to Mil-STD-202, Method 101, Test Condition A, for 96 hours under a 5% salt spray.
Humidity	Conforms to Mil-STD-202, Method 106, for 240 hours at 95% RH.
Shock	Rated to withstand 100g per Mil-STD-202, Method 213, Test Condition A.
Vibration	Rated to withstand 10g per Mil-STD-204, Test Condition A.
	Regulatory Compliance Summary
	Interrupt Capacity: Meets SAE J553, ABYC-E11, UL1077, CE Ignition Protected: SAE J1171 Endurance: SAE J553 Dielectric Strength: UL1077* Shock, Vibration, Corrosion, Humidity: Mil-STD-202 Weatherproof IP66

**tested per UL1077 methods*



1112 N. Garfield St. Lombard, IL 60148 helpme@mechprod.com
phone 630 | 953 | 4100 fax 630 | 953 | 4110 www.mechprod.com

Specifications subject to change

QC-4018-A

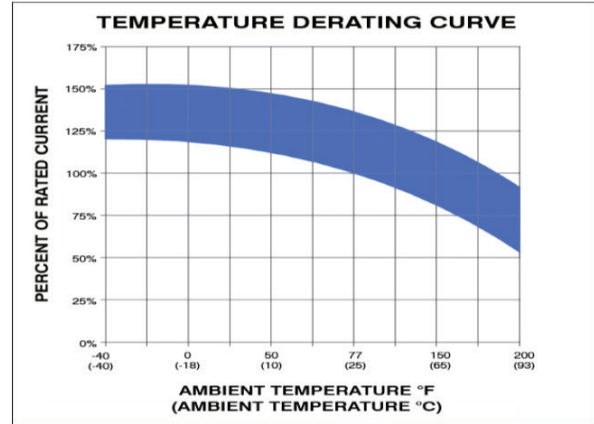
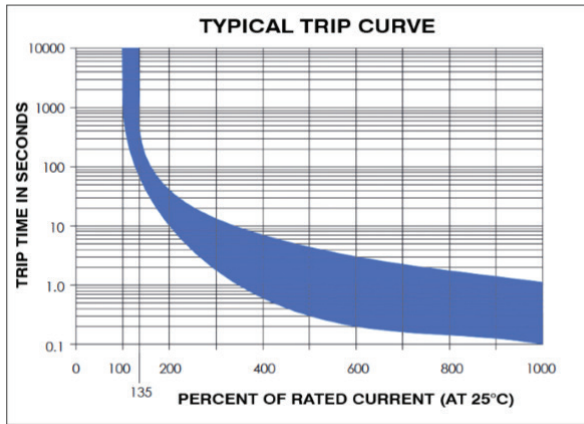

Typical Overload Trip Time Data (in seconds)

Current Rating	200%	400%	600%	800 %	1000%
25-250 Amps	10-40	0.6-7.0	0.2-3.0	0.15- 2.0	0.09-1.2

Typical Ambient Temperature Correction Factor

Current Rating	°F	-40	0	50	77	150	200
	°C	-40	-18	10	25	65	93
25-250 Amps		0.80	0.84	0.87	1.00	1.22	1.47

Series 87 Physical Configuration

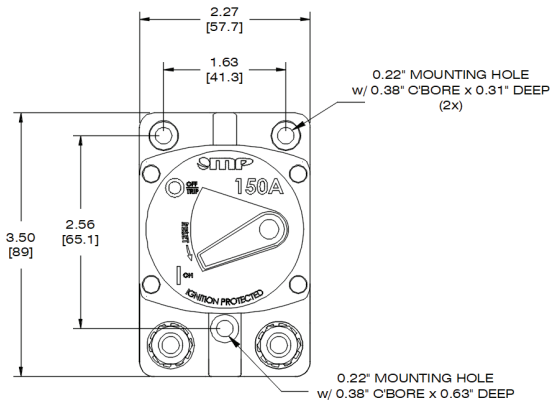

SURFACE MOUNT CONFIGURATION

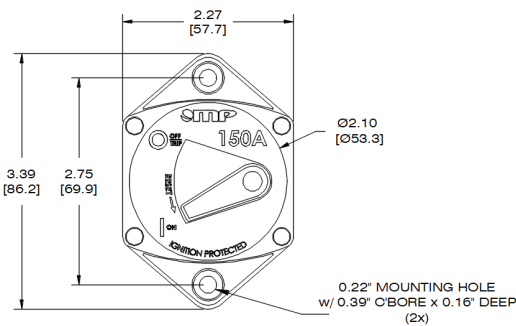
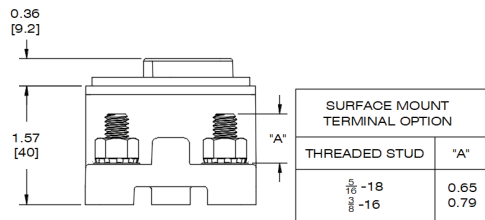

PANEL MOUNT CONFIGURATION

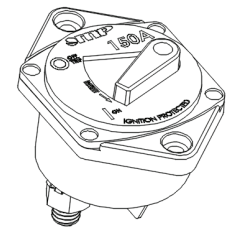
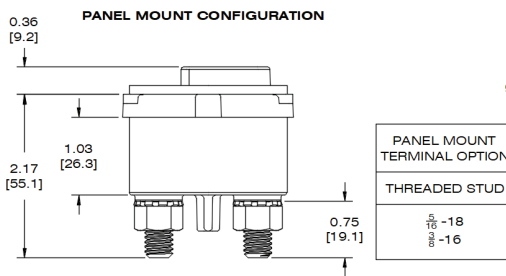

**PANEL MOUNTING
CUTOUT RECOMMENDATION**

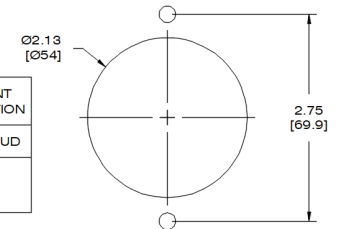

Series 87 Part Numbering Guide

P/N: 8 7 5 - - -

Series Number

87 = Series Circuit Protector

Vehicle Protection

5 = Type III Manual Reset

Mounting Options / Configurations

P = Panel Mount

S = Surface Mount

Terminal Options

1 = 5/16"-18 Stud

2 = 3/8"-16 Stud

Terminal Hardware

0 = No Terminal Hardware

1 = (2) SS Sems Nuts, Bulk

2 = (2) SS Sems Nuts, (Assembled)

Amp Rating

025 - 250 (25 to 250 Amps)



Series 87 Typical Applications

Ideal for DC power systems in marine as main or branch circuit breaker, truck and bus systems, RV systems, accessories, lift gates, etc.



1112 N. Garfield St. Lombard, IL 60148 helpme@mechprod.com
phone 630 | 953 | 4100 fax 630 | 953 | 4110 www.mechprod.com



WARNING: Cancer & Reproductive Harm
www.p65warnings.ca.gov/

Specifications subject to change

QC-4018-A