

SYMBOL DEFINITION		MISSING SYMBOLS	
A DIMENSION WITHOUT AN INSPECTION REPORT SYMBOL DOES NOT REQUIRE INSPECTION. IT MAY BE CONTROLLED ON THE INDIVIDUAL COMPONENT DRAWING.	TOTAL NO OF INSPECTIONS REQUIRED	NO MISSING SYMBOL NUMBER	
	7		
	LAST NO. USED		
	7		

DWG STATUS				REVISION HISTORY			
DATE	STB	REV	BY	ZONE	DESCRIPTION	DATE	BY
04M104	R	04	-	-	CLEARED REV COLUMN; ALL PARTS - ADDED NOTE 3		2542
060004	R	05	-	-	15317723 - CHANGED MATERIAL CODE TO M3620413 WAS M36204251 UPDATED FORMAT		2997
15MR05	R	06	-	-	ALL PARTS - PXX WAS PED, ADDED NOTE #4		2649
07JL11	R	07	-	-	ALL PARTS - UPDATED PDM ATTRIBUTES AND UPDATED MATERIAL CALLOUT		4147
19FE15	R	08	-	-	15317723 - ADDED TARNISH INFO NOTE		4288

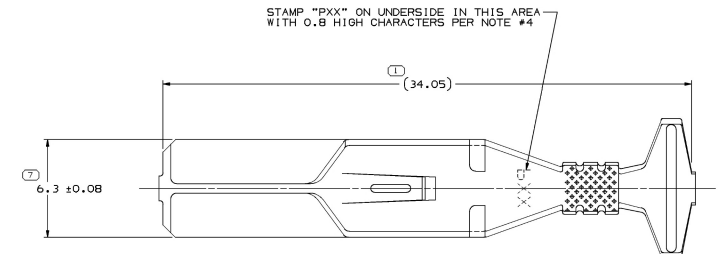

TYPE 101

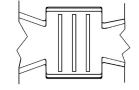

TYPE 103
SAME AS TYPE 102
EXCEPT AS SHOWN

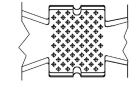

TYPE 102
SAME AS TYPE 101
EXCEPT AS SHOWN

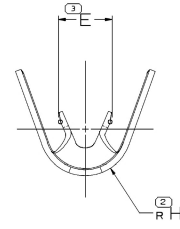
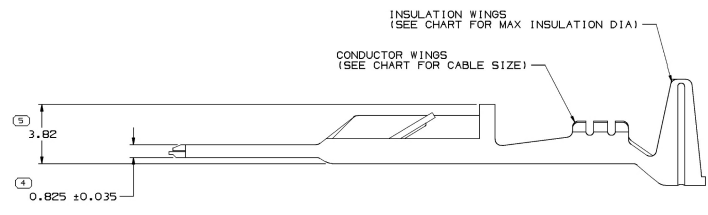
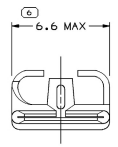

NOTES

- UNLESS OTHERWISE SPECIFIED AND/OR INDICATED:
DIMENSIONS ARE TO FACE OF VIEW SHOWN AND AUTOMATICALLY ROUNDED BY COMPUTER FOR INSPECTION (SEE MATH MODEL FOR PRECISE DIMENSIONS). FOR ALL OTHER DIMENSIONS NOT SHOWN BUT REQUIRED FOR TOOL BUILD, SEE MATH MODEL FOR PRECISE TOOL PATH DATA.
- MATING TERMINAL 12015932 OR EQUIVALENT.
- CUT OFF TAB DIMENSION FROM TIP OF TERMINAL TO BE 0.25mm MAX WITH NO BURR PERMISSIBLE.
- "PXX" INDICATES "P" PLUS LAST TWO DIGITS OF MAKE DIE SERIES NUMBER (P01, P02, P03, ETC).
- FOR TERMINALS PACKAGED & STORED IN THE APPROVED MANNER, TARNISH ON SILVER PLATED SURFACES WILL NOT AFFECT THE PERFORMANCE OF THE PART.

Q. REV	MAT'L SIZE	MAT'L SPEC	PART NO	REV	MAT'L SPEC	SIZE (MM ²)	I.D.	DIA	TYPE	E	H
	0.3B1 X 44.45		15317723	B5	AG PLATED COPPER ALLOY	6-4	10	5.24-3.55	103	5.6	3
	0.3B1 X 44.45		15317330	B3	TIN PLATED COPPER ALLOY	6-4	10	5.24-3.55	103	5.6	3
	0.3B1 X 44.45		12064737	D3	TIN PLATED COPPER ALLOY	3	12	4.9-3.97	102	4.6	2.8
	0.3B1 X 44.45		12064736	E3	TIN PLATED COPPER ALLOY	5	10	5.24-4.4	102	4.6	3
	0.3B1 X 44.45		12064735	C3	TIN PLATED COPPER ALLOY	2-1	15	3.59-2.56	102	3.7	2.9
	0.3B1 X 44.45		12064734	C3	TIN PLATED COPPER ALLOY	0.8-0.5	19	2.68-2.11	101	3.2	2.8

PROCESS SENSITIVE DIMENSION		TOLERANCE	
DIMENSIONS ENCLOSED IN () INDICATE DIFFERENT DIMENSIONING AND NO TOLERANCE LIMITS ARE ESTABLISHED.	FRONT	0	> 12
DIMENSIONS ENCLOSED IN [] INDICATE TOLERANCE UNLESS OTHERWISE SPECIFIED.	REAR	0	> 12
UNLESS OTHERWISE SPECIFIED	ALL DIMENSIONS ARE IN MILLIMETERS		

PART DRAWING	
VOLUME (GPT)	DISK (D)
UNLESS OTHERWISE SPECIFIED	
THIS DOCUMENT IS TO ACCORDANCE WITH THE 1983-1994 EDITION OF THE MIL-STD-883C METHOD 2000.1 FOR TESTING OF ELECTRICAL CONNECTORS. SPECIFIC TESTING METHODS MAY BE SHOWN SEPARATELY PER PORTION OF DRAWING.	
ALL DIMENSIONS ARE IN MILLIMETERS	

DELPHI
DELPHI PACKAGED ELECTRICAL/ELECTRONIC PARTS
COPYRIGHT 1987 DELPHI CORPORATION
THIS DRAWING IS THE PROPERTY OF DELPHI CORPORATION. IT IS TO BE USED ONLY FOR THE REPRODUCTION OF THIS DRAWING FOR THE PURPOSES OF THIS DRAWING AS SHOWN. REPRODUCTION OF THIS DRAWING FOR ANY OTHER PURPOSE IS PROHIBITED.

DR: ANDY T. LEE
APR03: E. HESTON
APR03: E.M. BARTLEY
APR04:
APR05:
SUBSTITUTES OF CONCORD AND R...
CONTENT PER DELPHI 1206586

DRAWING TITLE: TAXI TERM M/M/P 630 SE...
DRAWING NUMBER: 1206586
SIZE: B1
SHEET: 1 OF 1