

Mechanical Dimensions: Inches [mm]

Tolerances ± 0.012 [0.3] Unless Otherwise Specified

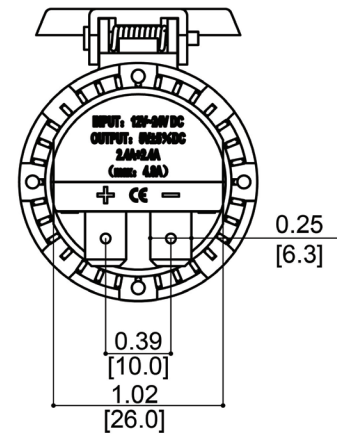
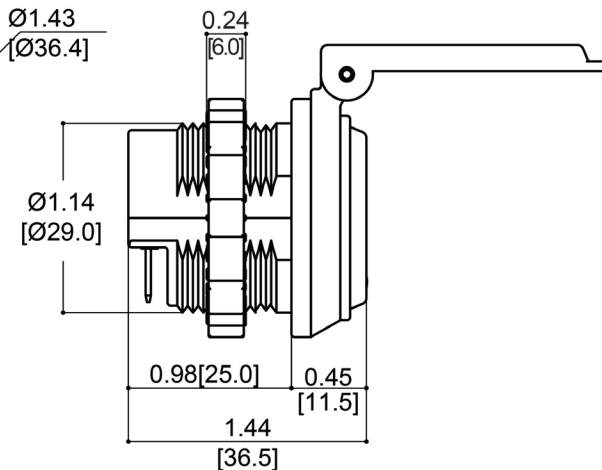
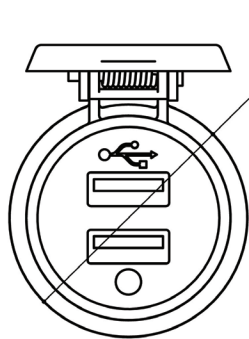
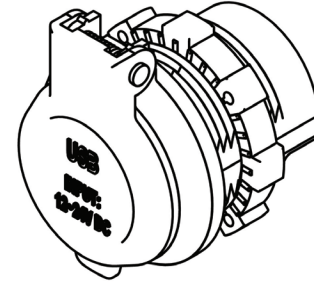
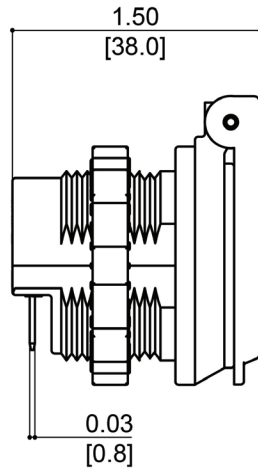
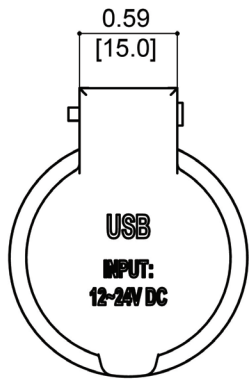

Electrical Specifications

Nominal Voltage	12/24VDC
Operating Voltage	12V/30VDC (max)
Peak Voltage	32VDC (max) (3~4 sec)
Output Rating (12VDC Input)	Type A Output 1 (5V; 2.4A) Type A Output 2 (5V; 2.4A) Type A + Type A (5V 2.4A + 5V 2.4A)
Output Rating (24VDC Input)	Type A Output 1 (5V; 2.4A) Type A Output 2 (5V; 2.4A) Type A + Type A (5V 2.4A + 5V 2.4A)
Operating Frequency	100~150Khz
Current Draw	20mA
Operating Temperature	-20 °C ~ 60 °C

Material Specifications

Two Type A USB Connections	
Terminals Material	Brass
Body Material	Reinforced Nylon
Mounting Hole	29mm diameter

Rev Date of issue Revision Notes

Designed Approved

A	07-16-2024	Initial Drawing	RC	OF
---	------------	-----------------	----	----