

SYMBOL DEFINITION		MISSING NUMBERS		DATE		JOB		REVISION HISTORY		AUT	
A DIMENSION WITHOUT AN INSPECTION REPORT SYMBOL DOES NOT REQUIRE INSPECTION. IT MAY BE CONTROLLED ON AN INDIVIDUAL COMPONENT DRAWING.		TOTAL NO. OF SYMBOLS ON DRAWING	LAST NO. USED	DATE	STB	REV	N/P	CHK	DATE	BY	CHK
		13	19	27AUG99	R	001	-	-	ALL ACTIVE PARTS - REDRAWN TO PD & ADDED CARRIER STRIP & SEAL ASSEMBLY INFORMATION	1990	
				27AUG99	R	002	-	-	ALL ACTIVE PARTS - LETTER DIM V WAS 20.2	1981	
				09JAN03	R	03	-	-	SHEET 1 OF 3 WAS SHEET 1 OF 2	2307	
				29NOV04	R	04	-	-	15305232 - REVISED MATERIAL CODE	2615	
				21FEB05	R	05	-	-	ALL ACTIVE PARTS - UPDATED MAT'L SPECS; REVISED MATING BLADE TOLERANCE (NOTE#211 7.05±0.3-0.2 WAS 7.05±0.25-0.3 & ADDED NOTE #5	2647	
				06JAN05	R	06	-	-	REVISED GRAPHICS	2681	
				27NOV06	R	07	-	-	UPDATED PDM ATTRIBUTES	2861	
				10JUL11	R	08	-	-	ALL ACTIVE PARTS - DIM "V" TOL WAS ±0.3	4148	
				15AUG12	R	09	-	-	UPDATED PDM ATTRIBUTES	4188	
				18FEB15	R	10	-	-	15305232 & 15317332 - ADDED TARNISH INFO NOTE	4288	

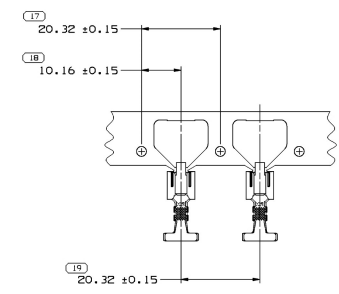
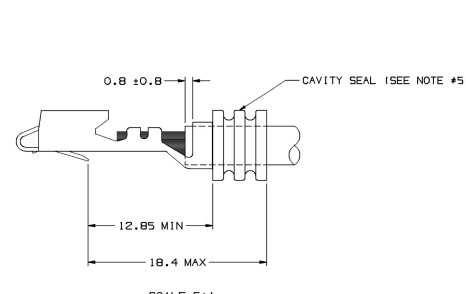
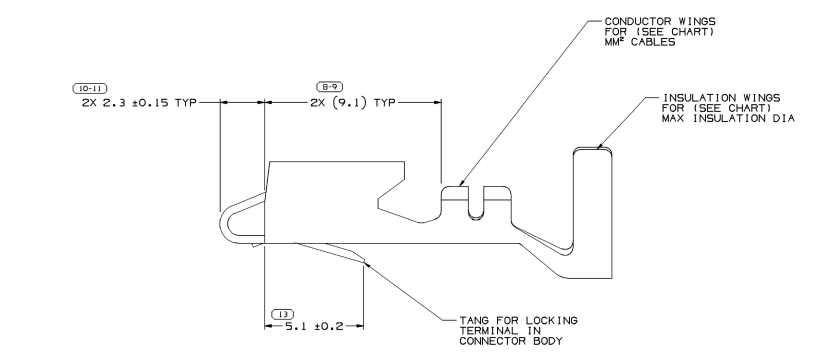
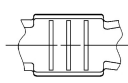
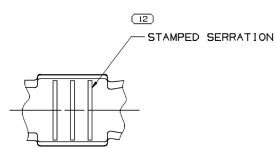
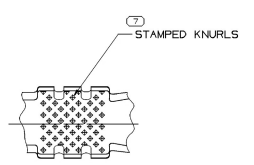
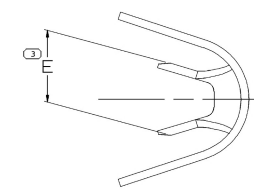
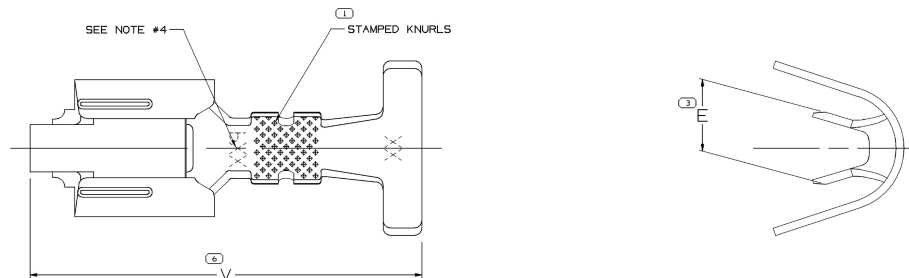
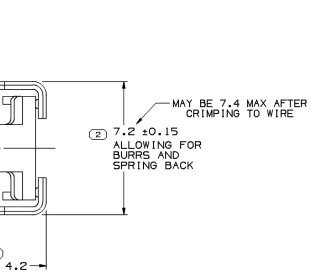

- NOTES
- UNLESS OTHERWISE SPECIFIED AND/OR INDICATED:
 - DIMENSIONS ARE TO FACE OF VIEW SHOWN AND AUTOMATICALLY ROUNDED BY COMPUTER FOR INSPECTION (SEE MATH MODEL FOR PRECISE DIMENSIONS). FOR ALL OTHER DIMENSIONS NOT SHOWN BUT REQUIRED FOR TOOL BUILD, SEE MATH MODEL FOR PRECISE TOOL PATH DATA.
 - RECOMMENDED MATING BLADE 0.8 +0.04/-0.03 THK X 6.3 ±0.1 WIDE.
 - THIS PART ACCEPTS THE FOLLOWING COMPONENTS OR EQUIVALENT:
 - TERMINAL 12020127
 - "PXX" INDICATES "P" PLUS LAST TWO DIGITS OF MAKE DIE SERIES NUMBER (P01, P02, P03, ETC).
 - TERMINAL TO CRIMP AND RETAIN CAVITY SEAL 120523B6 OR EQUIVALENT.
 - DO NOT PROBE, TEST OR OTHERWISE CONTACT THE INTERIOR REGION (THE SPRING OR ANY MOVING PART) OF THIS TERMINAL. SEVERE DAMAGE CAN OCCUR, COMPROMISING THE PERFORMANCE OF THE ELECTRICAL INTERFACE.
 - FOR TERMINALS PACKAGED & STORED IN THE APPROVED MANNER, TARNISH ON SILVER PLATED SURFACES WILL NOT AFFECT THE PERFORMANCE OF THE PART.

PART NO	REV/N/P	MAT'L SIZE	MAT'L SPEC	PART NO	REV/N/P	MAT'L SIZE	MAT'L SPEC	SIZE (MM ²)	ID	DIA	TYPE	E	V	
				15317332	03	AD	0.406 X 33.32	A6 PLATED COPPER NICKEL ALLOY	6-4	10	5.24	104	5.7	19.48
				15317331	03	AC	0.406 X 33.32	COPPER ALLOY	6-4	10	5.24	103	5.7	19.48
				15305232	02	AD	0.406 X 33.32	A6 PLATED COPPER NICKEL ALLOY	5-3	11	5.24	101	4.6	19.48
1206652	F	0.406 X 33.32	COPPER ALLOY	12052458	F	-	0.406 X 33.32	COPPER ALLOY	3	12	4.9	101	4.6	19.79
1206651	F	0.406 X 33.32	COPPER ALLOY	12052457	0B	AC	0.406 X 33.32	COPPER ALLOY	0.8-0.5	19	2.68	102	3.2	19.79
1206650	G	0.406 X 33.32	COPPER ALLOY	12052456	09	AC	0.406 X 33.32	COPPER ALLOY	5-3	11	5.24	101	4.6	19.48
1206653	E	0.406 X 33.32	COPPER ALLOY	12052455	07	AC	0.406 X 33.32	COPPER ALLOY	2-1	15	3.59	101	3.7	19.79

DELPHI
DELPHI PACKAGED ELECTRICAL/ELECTRONIC PARTS
COPYRIGHT 1998 DELPHI CORPORATION
ALL RIGHTS RESERVED
THIS DRAWING IS THE PROPERTY OF DELPHI CORPORATION AND IS NOT TO BE REPRODUCED OR TRANSMITTED IN ANY FORM OR BY ANY MEANS, ELECTRONIC OR MECHANICAL, INCLUDING PHOTOCOPYING, RECORDING, OR BY ANY INFORMATION STORAGE AND RETRIEVAL SYSTEM, WITHOUT THE WRITTEN PERMISSION OF DELPHI CORPORATION.

UNLESS OTHERWISE SPECIFIED:
DIMENSIONS ARE TO FACE OF VIEW SHOWN AND AUTOMATICALLY ROUNDED BY COMPUTER FOR INSPECTION (SEE MATH MODEL FOR PRECISE DIMENSIONS). FOR ALL OTHER DIMENSIONS NOT SHOWN BUT REQUIRED FOR TOOL BUILD, SEE MATH MODEL FOR PRECISE TOOL PATH DATA.
ALL DIMENSIONS ARE IN MILLIMETERS

PROCESS SENSITIVE DIMENSIONS
DIMENSIONS ENCLOSED IN () INDICATE DIFFERENTIAL DIMENSIONS AND NO TOLERANCE UNLESS OTHERWISE SPECIFIED.
TOLERANCE UNLESS OTHERWISE SPECIFIED:
HOLE SIZE (MM) ±0.02
ANGLE TO TOLERANCE ±0.2

THIRD ANGLE PROJECTION
DO NOT SCALE
USE MATH DATA

OR:
ANDY T. LE
AL GOLDEN
EX. D. BEARINGS

SUBSTITUTES OF CONDUCTOR AND RETAIN CONTACT PER DELPHI 12044

SEE CHART

DRAWING TITLE
TAXI TERM F M/P 630 SE

DRAWING NUMBER
1208801

SIZE
AD 10:1

SHEET 1 OF 1