

Positive Post Hole
Crimp Information

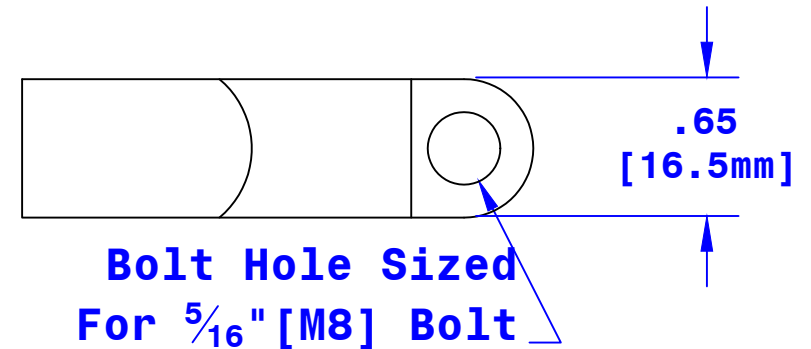

**Bolt Hole Sized
For 5/16" [M8] Bolt**

**.65"
[16.5mm]
Dia. Ref**

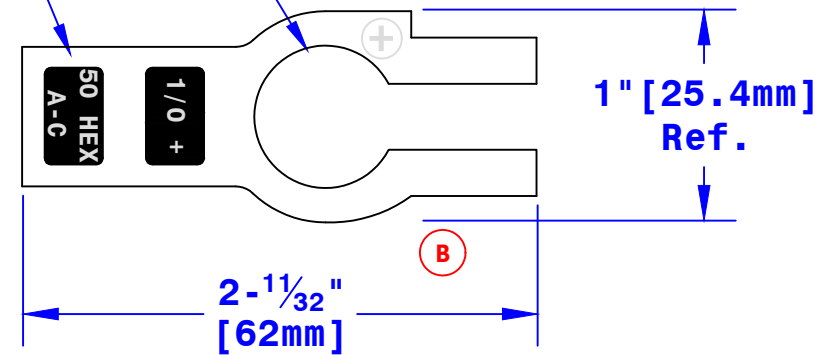
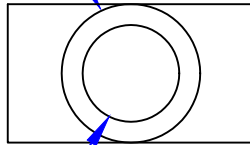

**I.D. Sized For 1/0
[50mm²] Stranded Cable
7/8" [22.2mm] Min Depth**

Property of QUICKCABLE® 3700 Quick Drive Franksville, WI 53126 U.S.A. www.quickcable.com	TITLE	
	Straight clamp	
	PART #	3010P
Confidential and Proprietary Information		
Material & Treatment	Drawing #	REV
High Conductivity Copper Alloy Bright Tin Plate	3010P-Info	D
Sheet 1 of 1		

D	04-09-18	3790	MTP	Added Positive Symbol
C	10-28-10	2201	JMH	Removed wording "Max" from dimensions
B	02-23-09	1759	JMH	Update print; remove one notch; shorten tangs
A	5-25-06	1285	JMH	Added color printing to tangs
Rev	Date	ECN#	By	Description

Drawn By	Date	Checked By	Scale
Paul	3-31-03	Mike E	None
Tolerances, unless otherwise noted			
Dimensions are reference only			