

JOSEPH POLLAK CORP. BOSTON, MASS 02122 U.S.A.

N0.52-620 REV C

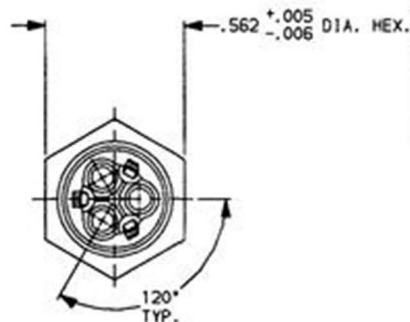
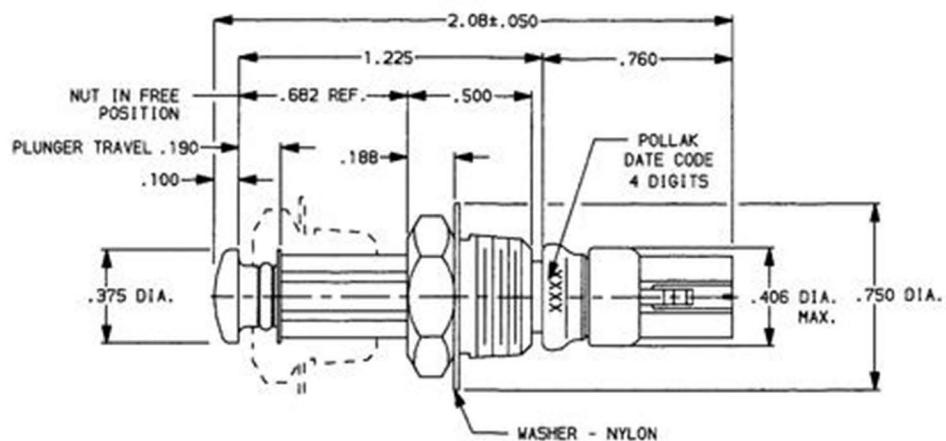

THIS VIEW SHOWN  
WITHOUT NYLON WASHER

BOSTON  
 STOUGHTON

WHERE  
USED

Ⓢ SWITCH INFORMATION:

1. REPLACES FORD P/N E80B-13713-AA AND CHRYSLER P/N 36003541.
2. RATING — 14 VOLTS AT 10 AMPS LAMP LOAD.
3. LIFE — 80,000 CYCLES.
4. ACTUATING FORCE INITIAL — 5 TO 8 LBS. NOMINAL.
5. WEATHER-SEALED CONSTRUCTION.
6. NUT FREE TO ROTATE ON ADJUSTING SLEEVE.
7. ADJUSTMENT FORCE — 30 TO 115 LBS.  
(SWITCH SELF ADJUSTS ON FIRST DOOR CLOSURE).

Ⓢ (OPTIONAL) MATING CONNECTOR INFORMATION

- (1) CONNECTOR SET SHALL CONSIST OF,
  - (1) ea. 52-625 SHELL
  - (1) ea. 52-626 BOOT
  - (3) ea 52-627 PIN
- 52-621 = (UNASSEMBLED) CONNECTOR COMPONENT SET, BULK PACKAGED
- 52-622P = (ASSEMBLED) CONNECTOR SET W/ 8" WIRE LEADS, INDIVIDUALLY PACKAGED
- 52-624P = (52-620) SWITCH AND (52-622) CONNECTOR SET W/ 8" WIRE LEADS, INDIVIDUALLY PACKAGED

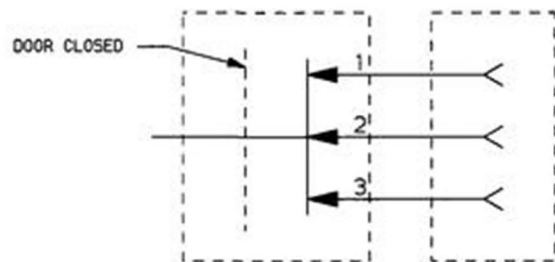

SWITCH SCHEMATIC  
SHOWN WITH PLUNGER IN  
DOOR OPEN POSITION

DESIGNED BY	DRAWN BY	BO	CHECKED BY	APPROVED BY	SCALE 2:1	2 PL. DEC. ± .025	3 PL. DEC. ± .015	ANGLES ±	DATE 5-21-92	
THIS DOCUMENT CONTAINS PROPRIETARY INFORMATION AND SUCH INFORMATION MAY NOT BE DISCLOSED TO OTHERS FOR ANY PURPOSE OR USED FOR MANUFACTURING PURPOSES WITHOUT WRITTEN PERMISSION FROM THE JOSEPH POLLAK CORPORATION.										
ECN	REVISIONS-AUTHORIZED-CHANGED-DATE									
15027	B	REDRAW ON CAD WITH CHANGES								BO 5-21-92
50559	C	BODY SLEEVE MATL CHGD FROM BRASS TO COPPER								NINA 3-15-94
									FINISH	
TITLE									REV C	
PLUNGER SWITCH										
N0.52-620										

A REL. TO PROD.	<i>lme</i>	(18207) bw 4APR96	D	NUMBER	52-624	REV.	A
B			E				
C			F				

USED ON

- BOSTON
- STOUGHTON

WIRE & TERMINAL ASSY: 2PLCS  
 18 GA GPT WIRE W/  
 (1) PIONEER TERMINAL  
 P/N 12047767-L  
 PER WIRE

CONNECTOR  
 PIONEER P/N 12059251

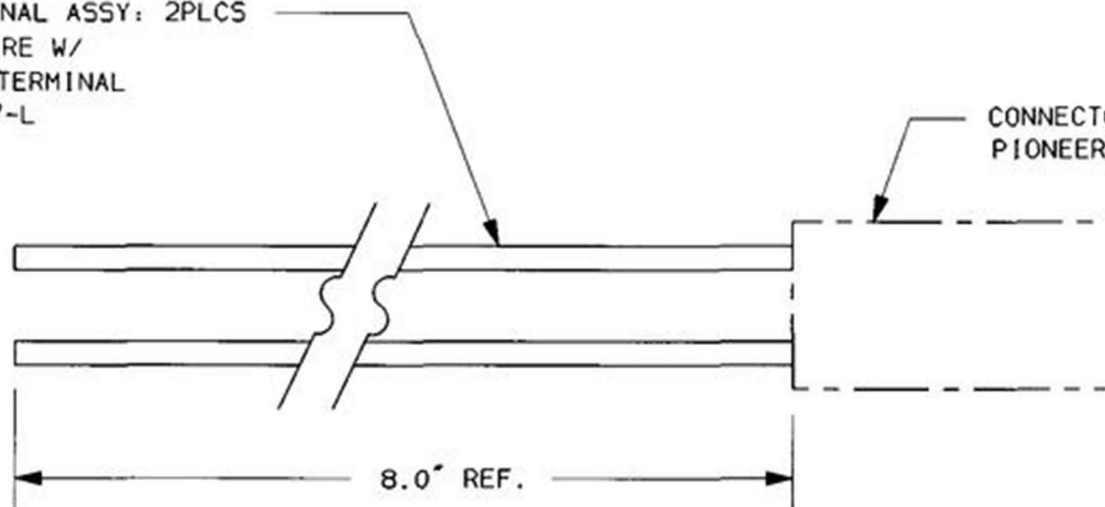

NOTE: THIS DRAWING SUPERSEDES DRAWING P/N 52-642.

MATERIAL	<i>∞</i>	DESIGNED	JL	DATE: 14FEB96	SCALE: <i>∞</i>	TITLE	NUMBER
JOSEPH POLLAK CORP		DRAWN	BW	TOLERANCES	2PL DEC ± <i>∞</i>	CONNECTOR SET	52-624
BOSTON, MA		CHECKED	<i>BW</i>	OTHER THAN	3PL DEC ± <i>∞</i>		
02122, USA		APPROVED		SPECIFIED	ANGLES ± <i>∞</i>		

52-624\_A