

DASH NO. RANGE	"D" DIA. RANGE	"E" DIMENSION		"G" GAP	"R" RADIUS	"T" GAUGE	
		ALUMINUM	STEEL			ALUM.	STEEL
-2	1/8"	"D"/2 + .395	"D"/2 + .395	.062/.078	.062	.032	.032
-3 THRU -8	3/16" TO 1/2"	"D"/2 + .405	"D"/2 + .405				
-9 THRU -12	9/16" TO 3/4"	"D"/2 + .471	"D"/2 + .468	.109	.050		
-13 THRU -17	13/16" TO 1-1/16"		"D"/2 + .452				
-18 THRU -30	1-1/8" TO 1-7/8"	"D"/2 + .500	"D"/2 + .468	.094/.125	.125	.062	
-31 THRU -96	1-15/16" TO 6"		"D"/2 + .476				.125/.156



S325

REV.	CHANGE	DATE	BY	CHK'D	APPR
AC	SEE DRAWING CHANGE RECORD ON FILE.	11/6/17	STR	HAD	STR

MATERIAL & FINISH CODES:

METAL: "NO CODE" 1008/1020 LOW CARBON STEEL PER ASTM A 1008, ASTM A 109, QQ-S-698
 FINISH: ZINC PLATE BRIGHT PER ASTM B 633, Fe/Zn 13, TY. III ①
 "D" 2024-T42 ALUMINUM ALLOY PER AMS-QQ-A-250/5
 "DK" 5052-H32 1/4 HARD ALUMINUM ALLOY PER AMS-QQ-A-250/8 ③
 "DL" 6061-T6 ALUMINUM ALLOY PER AMS-QQ-A-250/11
 FINISH: NONE
 "C" 316 STAINLESS STEEL PER AMS 5524
 "CV" 201 STAINLESS STEEL PER ASTM A 666
 "SS" 304/321 STAINLESS STEEL PER AMS 5513/AMS 5510
 "SV" 430 STAINLESS STEEL PER AMS 5503
 FINISH: NONE

CUSHION: "F" NITRILE BUTADIENE PER AMS 3215
 COLOR: YELLOW, SHAPES: A, WEDGE AVAILABLE
 "G" GENERAL PURPOSE EPDM PER SAE J200 M3 BA 710 C12
 COLOR: BLACK, SHAPES: A & B
 "EL" ETHYLENE PROPYLENE PER SAE J200 M3 BA 710 C12
 COLOR: WHITE, SHAPES: A & B
 "H" GENERAL PURPOSE SILICONE PER AMS 3303
 WITH 100 PSI MIN. TEAR
 COLOR: RED/ORANGE, SHAPES: A & B
 "HL" GENERAL PURPOSE SILICONE PER AMS 3303 & MIL-C-8603
 WITH 100 PSI MIN. TEAR
 COLOR: NATURAL WHITE, SHAPES: A, WEDGE AVAILABLE

"N" GENERAL PURPOSE NEOPRENE PER AMS 3209
 COLOR: BLACK, SHAPES: A & B, WEDGE AVAILABLE
 "B" GENERAL PURPOSE NEOPRENE PLUS BIOCIDIC PER AMS 3209
 COLOR: BLACK, SHAPES: A
 "T" TEFLON SKIVED PER AMS 3652
 COLOR: WHITE, SHAPES: A, WEDGE AVAILABLE
 "X" TEFLON ANTI-SLIP PER AMS 3652
 FINISH: SODIUM TREAT PER AMS 2491
 COLOR: BROWN, SHAPES: A, WEDGE AVAILABLE

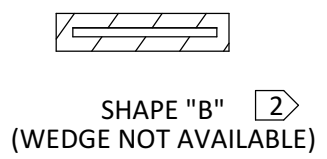
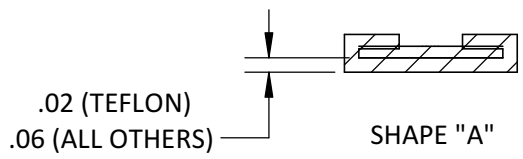
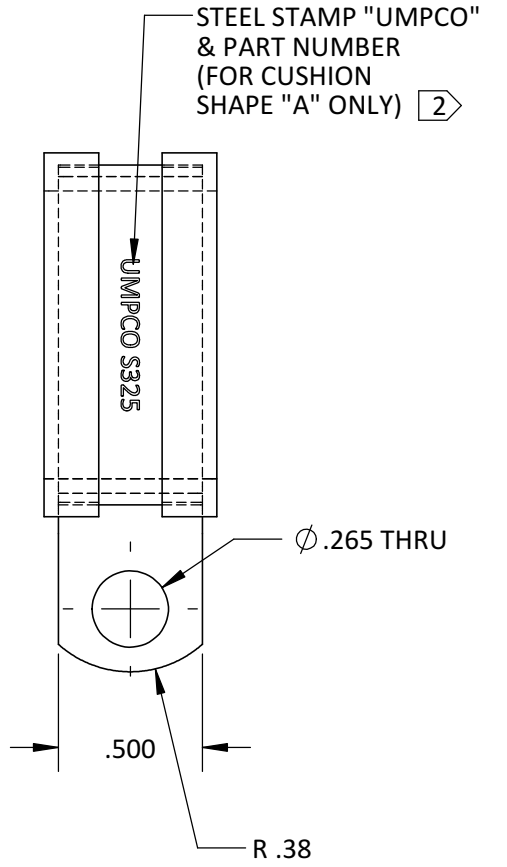
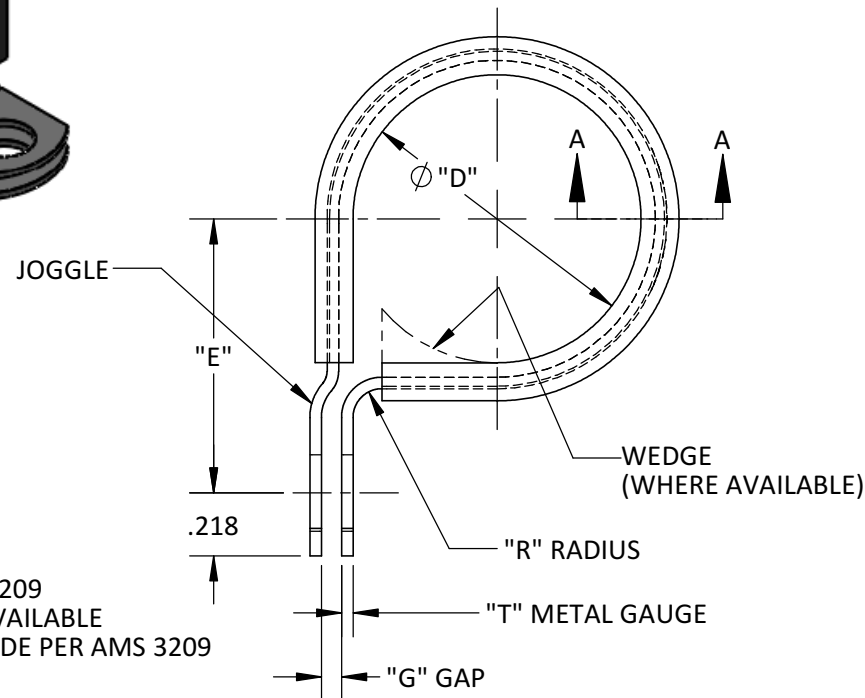

SECTION A-A (CUSHION STYLE)

EXAMPLE OF PART CALLOUT:

1" DIA., ALUM. CLAMP W/WEDGED TEFLON

S325 W D T R 16

DIA "D" IN 1/16" INCREMENTS
 RECTANGULAR CUSHION (OMIT WHEN NOT APPLICABLE)
 CUSHION CODE
 METAL CODE (OMIT FOR "NO CODE")
 WEDGE CODE (OMIT WHEN NOT APPLICABLE)
 BASIC DRAWING NUMBER

NOTES:

- ① OPTIONAL FINISH: CADMIUM PLATE BRIGHT PER AMS-QQ-P-416, TY. I, CL. 2
- ② FOR SHAPE (B) STYLE CUSHIONS (BOX), PARTS SHALL BE PACKAGE IDENTIFIED IN MULTIPLES OF 10, NOT TO EXCEED 100.
- ③ CAUSTIC ETCH TO CLEAN AS NEEDED.
- 4) CLAMPS FURNISHED IN THE NORMAL OPEN (SPRINGBACK) CONDITION.
- 5) INSPECT PER MIL-C-8603 CLOSURE TEST.

REFERENCES: -	-	-	FSCM/CAGE CODE No. 18076		
LIMITS ON DIMENSIONS UNLESS OTHERWISE SPECIFIED:	ANGULAR:	X	± 5°		KEL
	DECIMAL:	.XX	± .03		
GENERAL MACHINE FINISHES EXCEPT AS NOTED:		.XXX	± .015		KWE
	INTERPRET GEOMETRIC TOLERANCING PER: ASME-Y14.5M				09/30/55
REMOVE ALL BURRS AND BREAK SHARP EDGES .010 MAX	ACT. WGHT.	7100 LAMPSON AVE. P.O. BOX 5158 GARDEN GROVE, CA. 92846			07/24/06
	CALC. WGHT.	CLAMP, LOOP, SUPPORT, CUSHIONED 1/4" MOUNTING HOLE, LIGHT/MEDIUM DUTY			07/24/06
PART AND/OR ASSEMBLY DESCRIPTION				SIZE	ENGR
				B	SCALE: NONE
				S325	PRINT NUMBER