

# RENNSTEIG TOOLS, INC.

## PRODUCT NAME

Rennsteig Crimping Die Set & Locator for OCS 1.5 series terminals

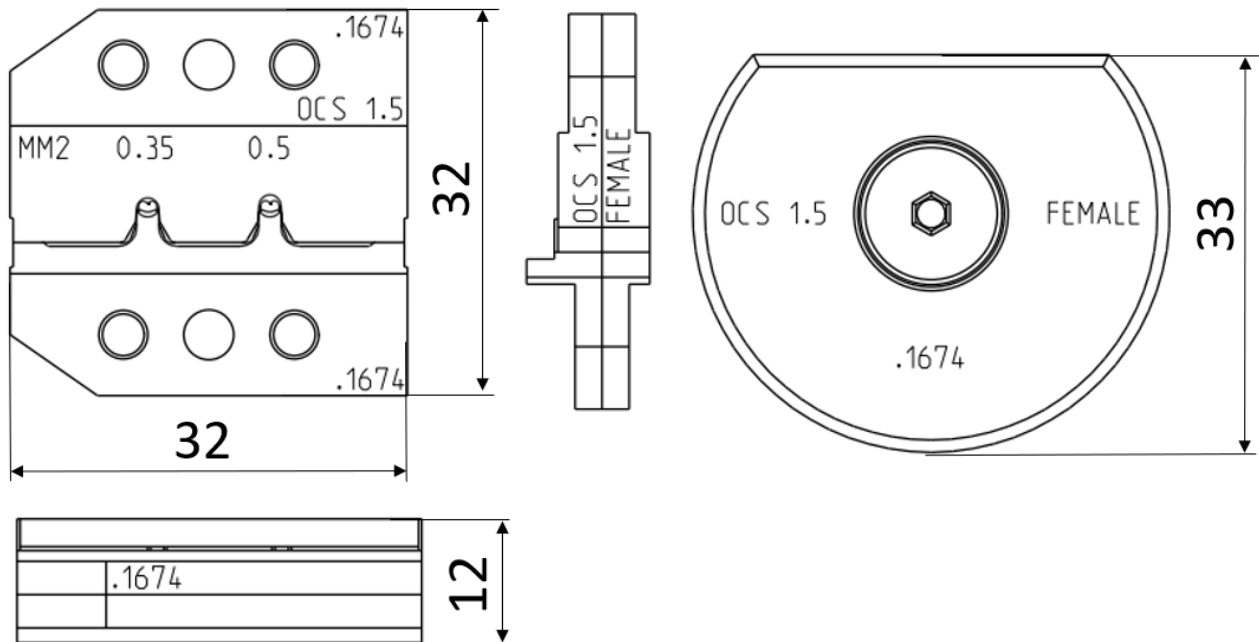

Measurements in Millimeter.

## SPECIFICATION

P/N	Description	Application	Terminal P/N	Capacity	Applicable for
624 1674 3 0 RT	Die Set	Econoseal 070	13849929	AWG 22 / 20 0.35 / 0.5 SQ-MM	Rennsteig Crimp System Tools
624 1674 0 01 RT	Locator	Econoseal 070	13849929	AWG 22 / 20 0.35 / 0.5 SQ-MM	Rennsteig Crimp System Tools

## CRIMP SPECIFICATION

### Core Crimp

Terminal	Wire Size	Crimp height CCH (mm)	Crimp width CCW (mm)	Pull out force (N) DIN EN 60352-2
13849929	AWG 22 / 0.35 SQ-MM	0.90 ± 0.05	1.60 ± 0.10	40 (nominal)
13849929	AWG 20 / 0.5 SQ-MM	0.95 ± 0.05	1.60 ± 0.10	60 (nominal)

### Insulation Crimp

Terminal	Wire Size	Insulation height ICH (mm)	Insulation width ICW (mm)	
13849929	AWG 22 / 0.35 SQ-MM	1.60 ± 0.10	1.80 ± 0.10	
13849929	AWG 20 / 0.5 SQ-MM	1.90 ± 0.10	1.80 ± 0.10	

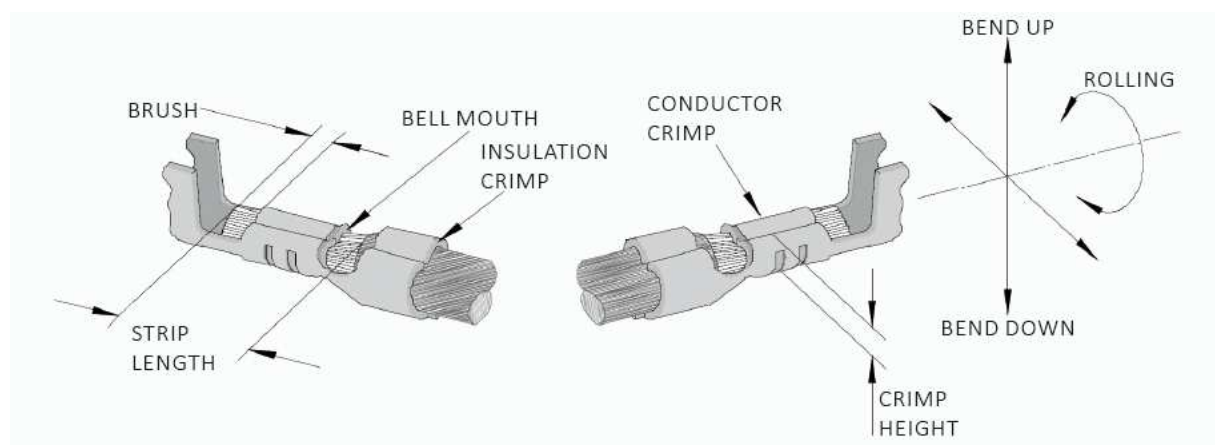

The above terminal drawing is a generic terminal representation. It is not an image of a terminal listed in the scope.