

RENNSTEIG TOOLS, INC.

PRODUCT NAME

Rennsteig Crimping Die Set, Wire Stop & Support for TE Female Power Timer Sealed & MCP 4.8K terminals

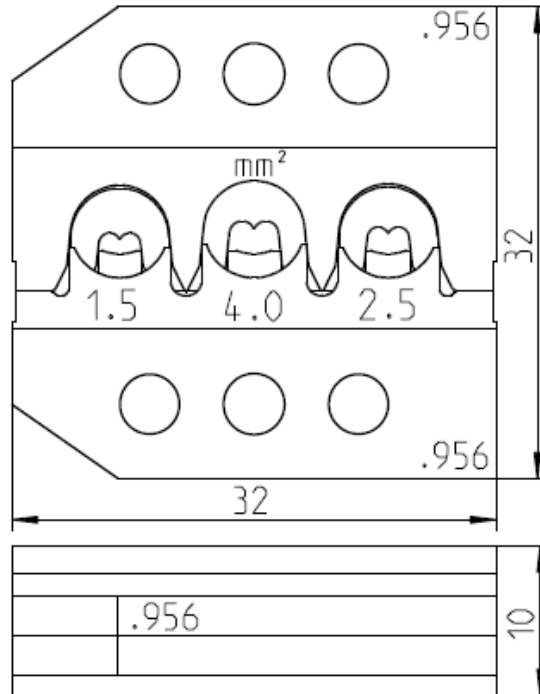

Measurements in Millimeter.

SPECIFICATION

P/N	Description	Application	Terminal P/N	Capacity	Applicable for
624 956 3 0	Die Set	1241414 / 1241415 & 969042 / 969043, 1241416 / 1241417 & 969044 / 969045	1.5 – 4.0 mm ²	Rennsteig Crimp System Tools	624 956 3 0

CRIMP SPECIFICATION

Core Crimp

Terminal	Wire Size	Crimp height CCH (mm)	Crimp width CCW (mm)	Pull out force (N) DIN EN 60352-2
1241414/1241515 & 969042/969043	> 1.0 – 2.5mm ²	1.69 ± 0.1	2.80 ± 0.05	130 (nominal)
1241414/1241515 & 969042/969043	> 1.0 – 2.5mm ²	1.97 ± 0.1	2.80 ± 0.05	190 (nominal)
1241416/1241417 & 969045/969044	> 2.5 - 4.0mm ²	2.34 ± 0.1	3.30 ± 0.05	270 (nominal)

Insulation Crimp

Terminal	Wire Size	Insulation height ICH (mm)	Insulation width ICW (mm)
1241414/1241515 & 969042/969043	1.5 mm ²	-	6.60 ± 0.05
1241414/1241515 & 969042/969043	2.5 mm ²	-	6.60 ± 0.05
1241416/1241417 & 969045/969044	4.0 mm ²	-	6.86 ± 0.05

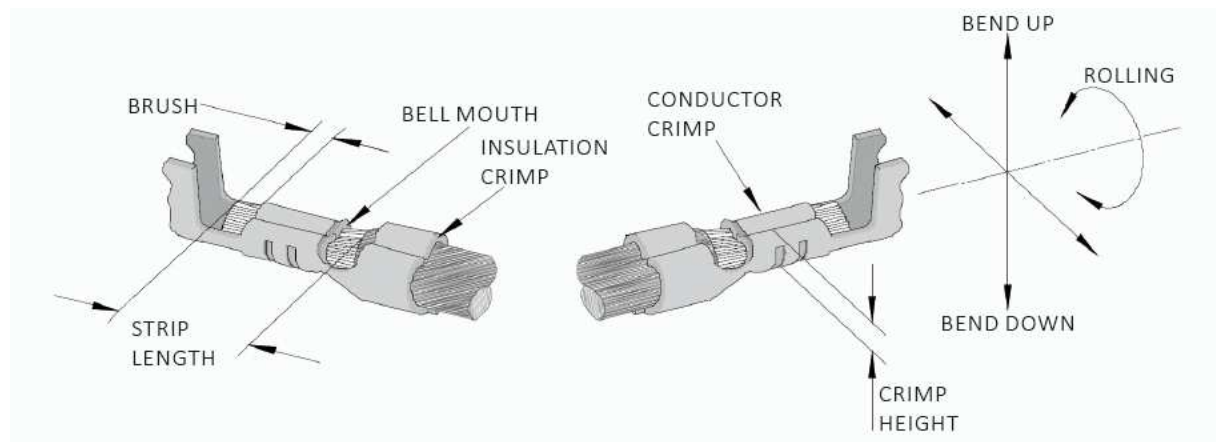

The above terminal drawing is a generic terminal representation. It is not an image of a terminal listed in the scope.