



## Mini Automatic Charging Relay (D-VSR)



P/N: 6601

### Installation Manual & General Specifications

[egismobile.com](http://egismobile.com)

#### Specifications

Nominal Voltage (Vdc) (Auto Sensing)	12	24
Operating Voltages - Combine (Vdc)	13.3	26.6
Operating Voltages - Open (Vdc)	12.8	25.6
Continuous Current (Amps)	125	
Intermittent Current (Amps)	140	
Low Voltage Lockout (Vdc)	9.5	19.0
Over Voltage Lockout (Vdc)	16.0	30.0
Operating Current Draw (mA)	270	
Operating Current (mA) Standby	3	
Terminal Studs	M6 (1/4")	
Ingress Protection	IP67	
Ignition Protection	ISO 8846 / SAE J1171	
Housing Material	Glass-Fiber Nylon	



**\* DISCONNECT ALL BATTERY  
OR OTHER POWER SOURCES  
FROM ELECTRICAL SYSTEM  
BEFORE INSTALLING  
PRODUCT TO PREVENT  
ELECTRICAL SHOCK OR  
PRODUCT DAMAGE**

*\* These instructions are  
intended to provide assistance  
with the installation of this  
product, and are not a  
substitute for a more  
comprehensive understanding  
of electrical systems. We  
strongly recommend that a  
competent electrical  
professional perform the  
installation of this product*

#### Installation Instructions

1. Disconnect the ring terminal from BAT stud.
2. Connect start battery to the "ENG" terminal stud, connect house battery to the "BAT" terminal stud.
3. Connect ground to the GND quick connect position of the DVSR
4. Connect the "KEY" ring terminal to BAT stud, or alternatively, cut the wire and connect it to a Vdc+ ignition switch to completely shut off the DVSR when not in use.
5. Optional - Remote LED - Use 12V or 24V as appropriate for application. Connect LED negative to "LED" terminal. Connect LED positive to +Vdc source with appropriate circuit protection inline.
6. Optional - Manual Override - connect ground wire to "MANU" and run to a switch. When ground is applied to manual, the device will turn on.
7. Mount the DVSR in either the panel or surface mount orientation.

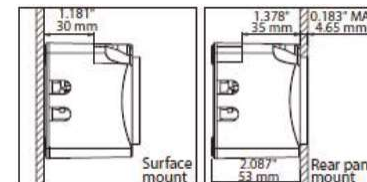

#### System Diagram

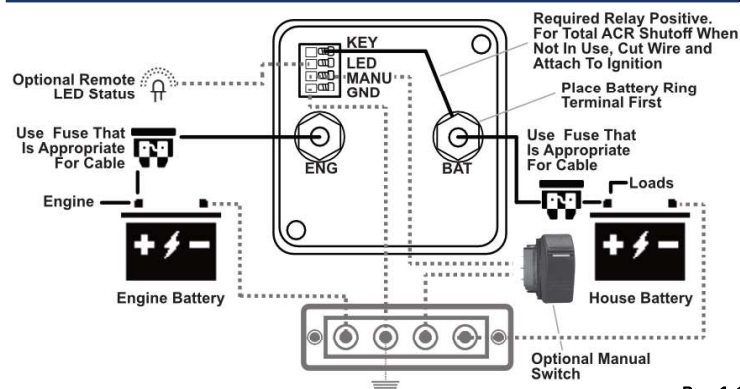

Rev 1.1