

LTR.	REVISIONS	DATE
A	ADDED #3652 AND #3653	24JAN03
B	3850-000 WAS 3850, 3850-001 ADDED 2 PLCS.	02MAR
C	ADDED CALLOUT FOR SPACER AND INSTRUCTION SHEET	01MAY07
D	REVISED TORQUE RECOMMENDATIONS	08JUN10

USE GREENLEE
PUNCH ASSEMBLY
#60098 FOR PANEL
CUTOUT

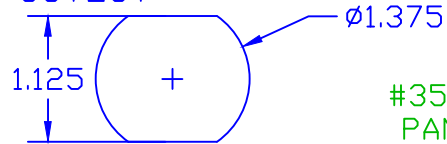

ASSEMBLY #7B5051W

(B)

#3551 N14 INNER
PANEL BUSHING
#3850-001 1/2"-13
S.S. HEX JAM NUT 2 PLCS.

P/N 3753
BRASS HEX
THREADED STUD

#3650 1/2" SS LOCKWASHER
2 PLCS.

1/4" PANEL

#3451 N14 OUTER PANEL BUSHING
#3651 FLAT WASHER
1" OD X 1/2" ID X .125

(B)

BLUE DOT TECHNOLOGY
#3850-000 1/2"-13 BRASS JAM NUT

(C)

P/N 330N5N** SPACER
(AS REQ'D.) BY INSTRUCTION
SHEET # 16805110901

P/N 379N9 V14 PANEL SEAL

DO NOT SCALE

INCLUDES P-16808110001 BLUE DOT MULTI LABEL, 1 PER CONTAINER

MAXIMUM AMPERAGE: 500 AMPS @ 12VDC

MAXIMUM RECOMMENDED FASTENER TORQUE:
BRASS JAM NUT: 240 IN./LBS.
S.S. JAM NUT: 180 IN./LBS.

INCLUDES: 232E4V14 WEATHERPROOFING TERMINAL COVER

BASE MATERIAL: GLASS-REINFORCED NYLON
BASE MATERIAL U.L. RATING: 94 HB
ITEMS SHOWN FOR ILLUSTRATIVE
PURPOSE, NOT INCLUDED:

4/0 GA. TERMINAL LUGS (2 PLACES)

TOLERANCE UNLESS OTHERWISE SPECIFIED: ±0.30"/±0.8mm
RADIAL DIAMETERS TO BE MEASURED OVER MANDRELS,
RING GAGES OR PIN GAGES OF SUITABLE SIZE

(D)

REF:	DATE:	DRN BY: BRH	WEIGHT:
***	02JAN03	CHK'D BY: BRH	***
TITLE: POWER BUSHING 1/2" STUD 1/4" MAX PANEL WEATHERPROOF			SCALE:
MATERIAL:		PART NO.	
COLOR: BLACK	DRG CLASS: ****		