

6

5

4

3

2

1

COVER

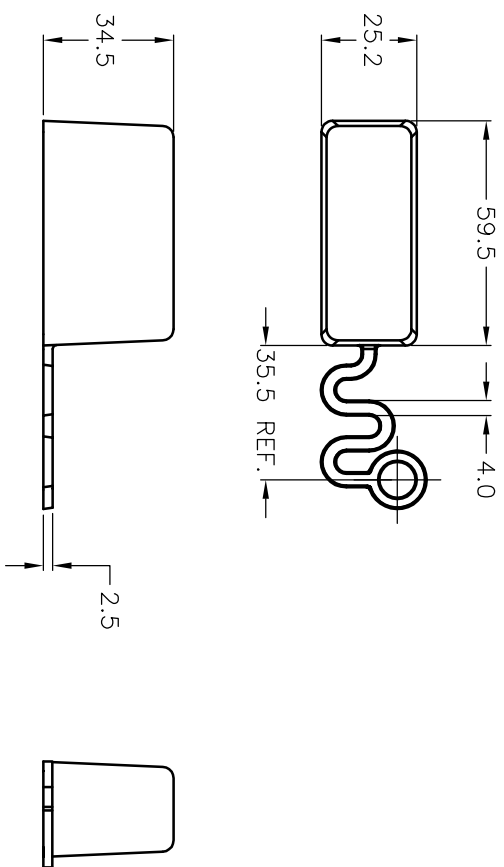

MATERIAL: SANTOPRENE TPV 251 70W 232

HOLDER

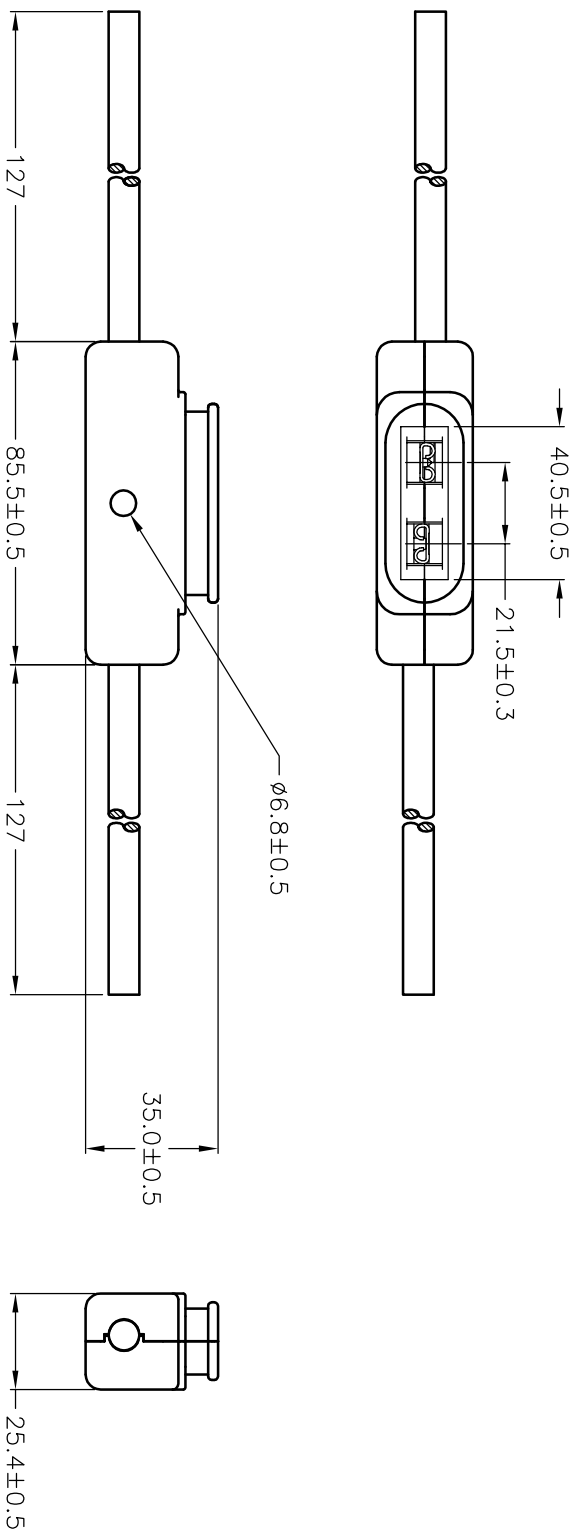

IN-LINE FUSE HOLDER FOR MAXI FUSES
SPECIFICATIONS:

INSULATION BODY: PC 125 C, HB / BLACK
CONTACTS: BRASS TIN-PLATED

CURRENT RATINGS: 60A FUSE, 48A; 80A FUSE 60 AMPS

FUSE INSERTION MIN.: 7.0 kgf [15.4 lbf]

FUSE INSERTION MAX.: 12.0 kgf [24.5 lbf]

WIRE PULL MIN.: 36.0 kgf [79.4]

WIRE SIZE: #6 UL3288 RED COLOR, 259 STRAND COPPER (NO PLATING), 125 C XL-PE

PART NO.

HHX-SALES

PLANT DISTRIBUTION CODE:

J U

REV #

REVISIONS

DATE APPR.

A INITIAL RELEASE
ECN BU-SB13806 BAM

7-24
2013

TOLERANCES UNLESS OTHERWISE SPECIFIED

METRIC	ENGLISH	FRACTIONAL TOL	THIRD ANGLE PROJECTION	DESIGN UNITS
1 PL DEC.=±0.25	2 PL DEC.=±0.01	±1/64 IN		METRIC (mm)
2 PL DEC.=±0.13	3 PL DEC.=±.005	ANGULAR TOL = ±1'		CREATED USING
		ANGULAR TOL 1PL=±0.5'		AUTOCAD

COPYRIGHT — Cooper Industries, Inc.

This is an unpublished work. The disclosure of this work is limited to a select personnel. Further dissemination or disclosure to the public is PROHIBITED. This unpublished work is protected by Federal Copyright Law and all rights thereunder are reserved by Cooper Industries, Inc.

CONFIDENTIAL —

The information contained in this document is the property of Cooper Industries, Inc. It is not for public disclosure. Possession of the information does not convey any right to loan, sell or disclose the information. Unauthorized reproduction or use of the information is PROHIBITED. This document is to be returned to Cooper Industries, Inc. upon completion of the purpose for which it is loaned or upon request.

MATERIAL

SEE NOTES

FINISH

SEE NOTES

COOPER Bussmann

St. Louis, MO 63178

TITLE
FUSEHOLDER WITH COVER

PART NO.

HHX-SALES

SHT 1 OF 1
SIZE: B

6

5

4

3

2

1

REV: 10/00